

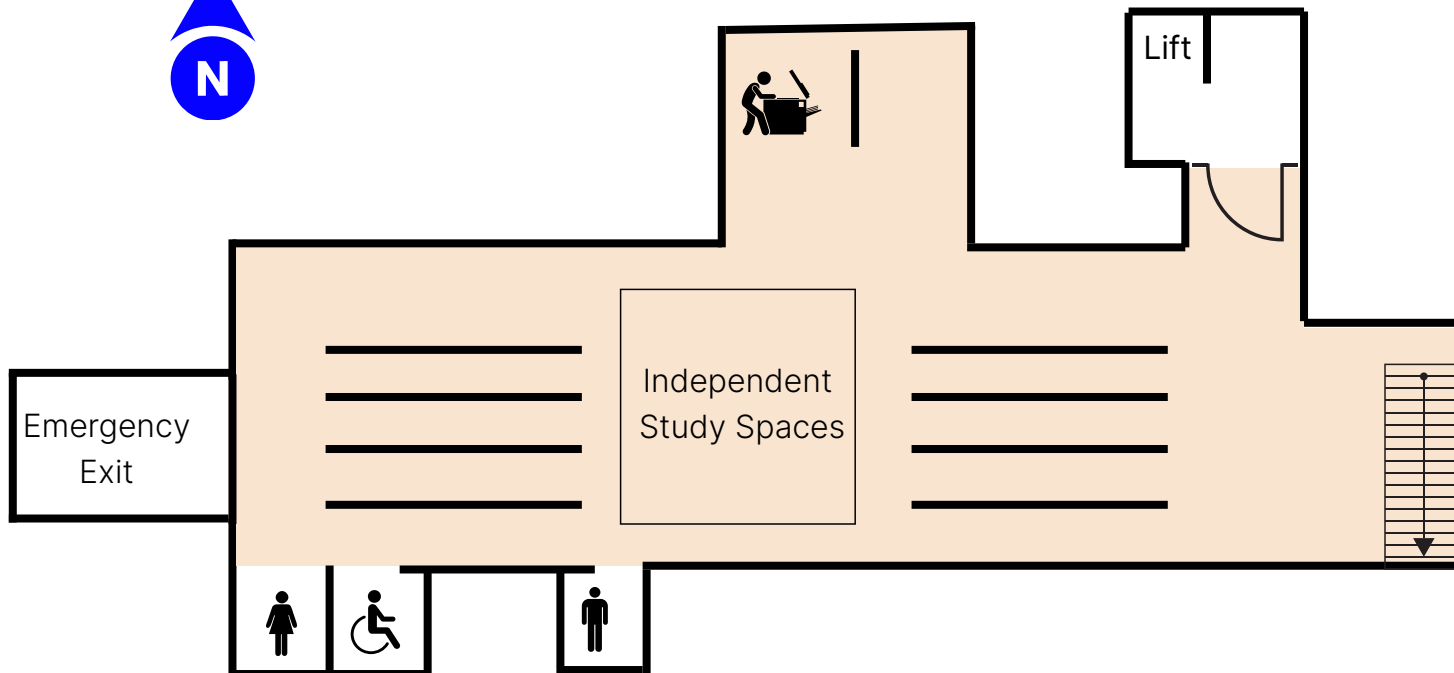

Mt Helen Library Sensory Map



Lower (Level 9)



The library's atmosphere varies depending on the day and time. It can be either quiet or busy with activity.

While Federation Library does not have designated sensory spaces, some spots tend to be quieter than others, as shown on the map.

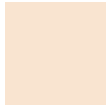
If you need assistance, please ask a library staff member.

-  **Lower sensory spaces**
Quieter areas with fewer people
-  **Higher sensory spaces**
Louder areas with visual and other stimuli
-  **Casual Seating**



Mt Helen Library Sensory Map

Ground Level (Level 0)

The library's atmosphere varies depending on the day and time. It can be either quiet or busy with activity.

While Federation Library does not have designated sensory spaces, some spots tend to be quieter than others, as shown on the map.

If you need assistance, please ask a library staff member.

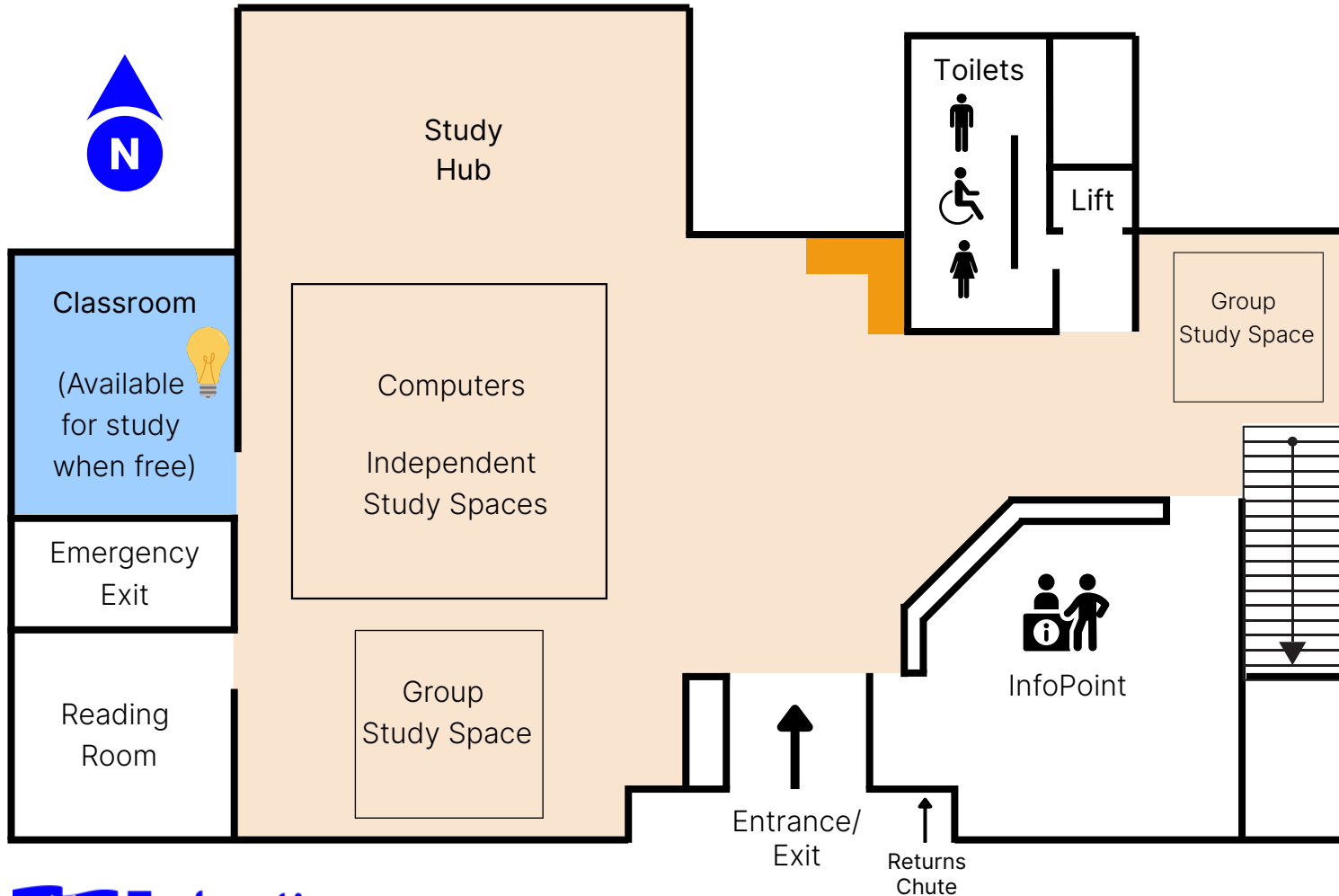

Lights can be dimmed/turned off

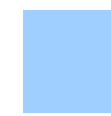

Lower sensory spaces
Quieter areas with fewer people



Higher sensory spaces
Louder areas with visual and other stimuli



Casual Seating



Mt Helen Library Sensory Map

Level 1

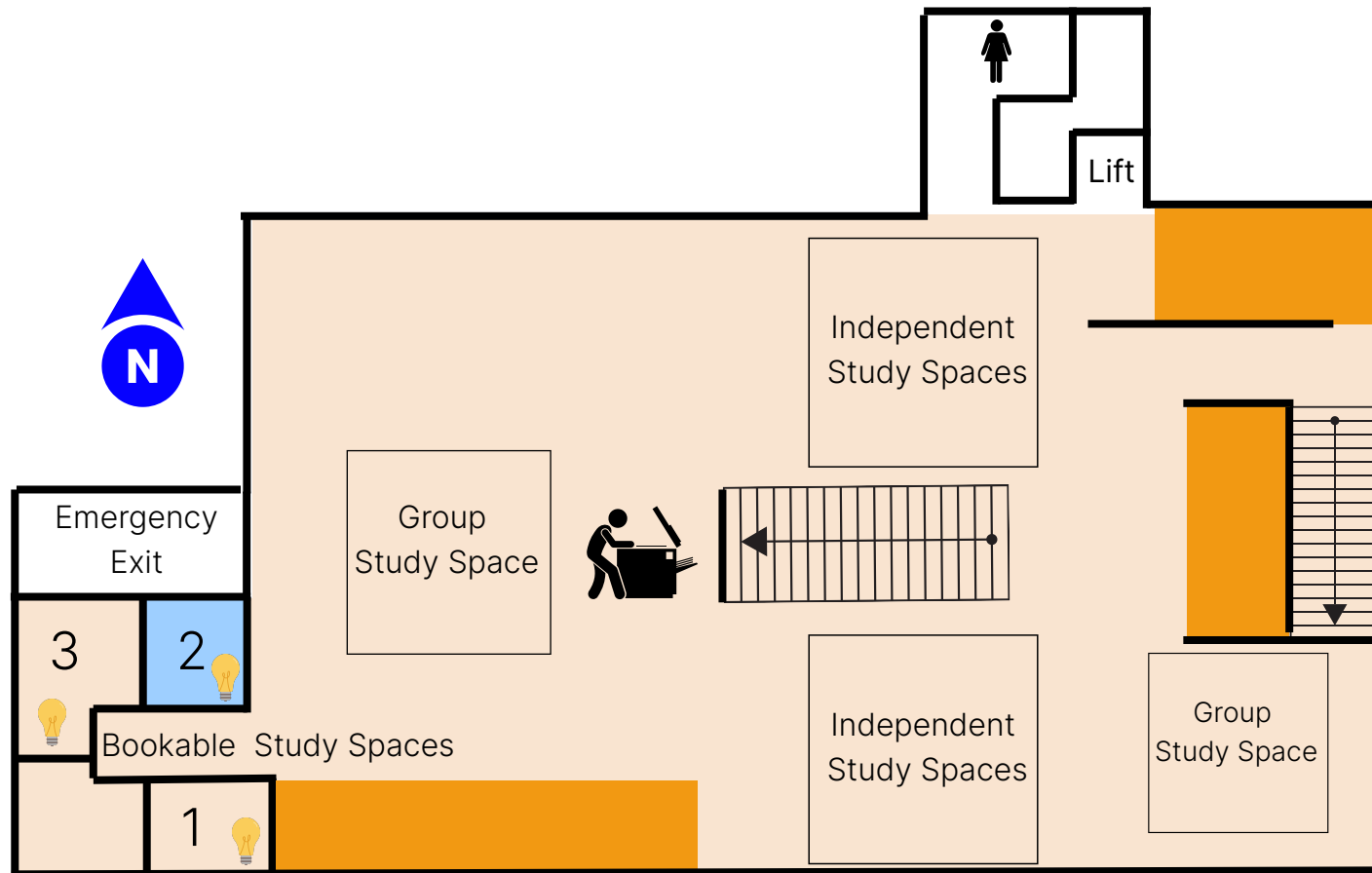

The library's atmosphere varies depending on the day and time. It can be either quiet or busy with activity.

While Federation Library does not have designated sensory spaces, some spots tend to be quieter than others, as shown on the map.

If you need assistance, please ask a library staff member.



Lights can be dimmed/turned off



Lower sensory spaces
Quieter areas with fewer people



Higher sensory spaces
Louder areas with visual and other stimuli



Casual seating



Mt Helen Library Sensory Map

Level 2

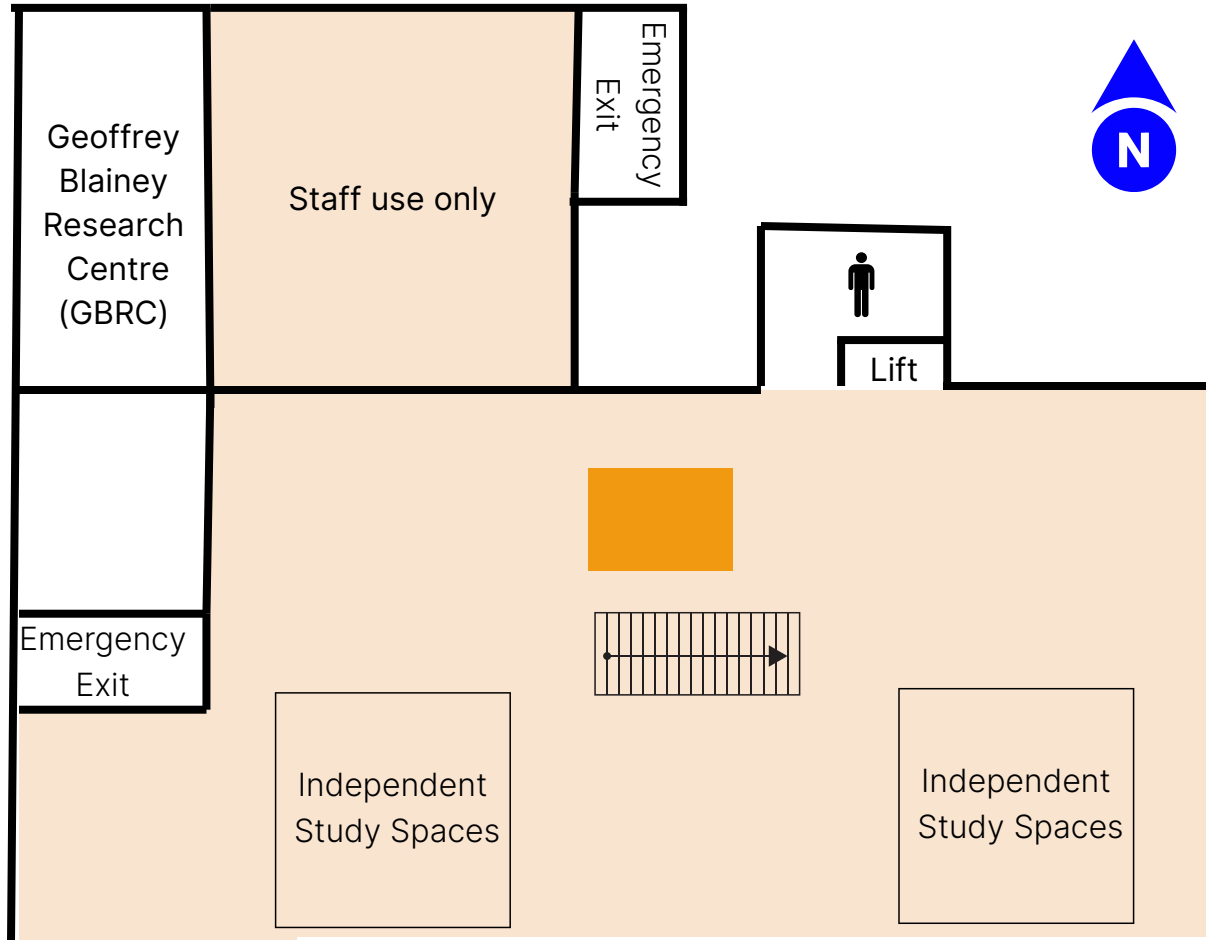

The library's atmosphere varies depending on the day and time. It can be either quiet or busy with activity.

While Federation Library does not have designated sensory spaces, some spots tend to be quieter than others, as shown on the map.

If you need assistance, please ask a library staff member.



Lights can be dimmed/turned off



Lower sensory spaces
Quieter areas with fewer people



Higher sensory spaces
Louder areas with visual and other stimuli



Casual Seating