



Gippsland Library Sensory Map

Ground Level (Level G)

The library's atmosphere varies depending on the day and time. It can be either quiet or busy with activity.

While Federation Library does not have designated sensory spaces, some spots tend to be quieter than others, as shown on the map.

If you need assistance, please ask a library staff member.

For a dedicated sensory space visit Student Connect to book room 3N-112 on the Gippsland campus

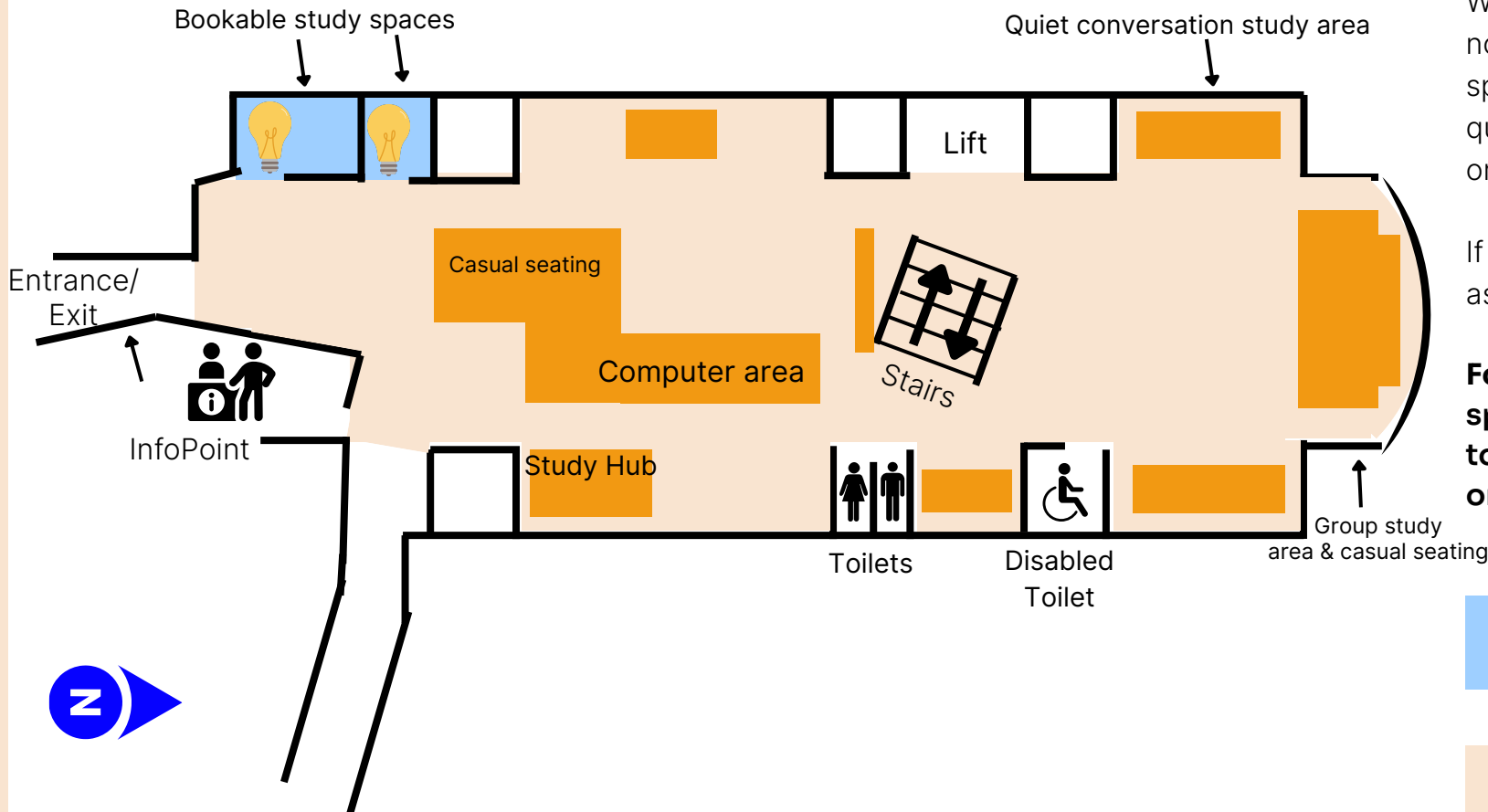

Lower sensory spaces
Quieter areas with fewer people

Higher sensory spaces
Louder areas with visual and other stimuli

Seating areas

 **Lights can be dimmed/turned off**



Gippsland Library Sensory Map

Basement Level (Level LG)

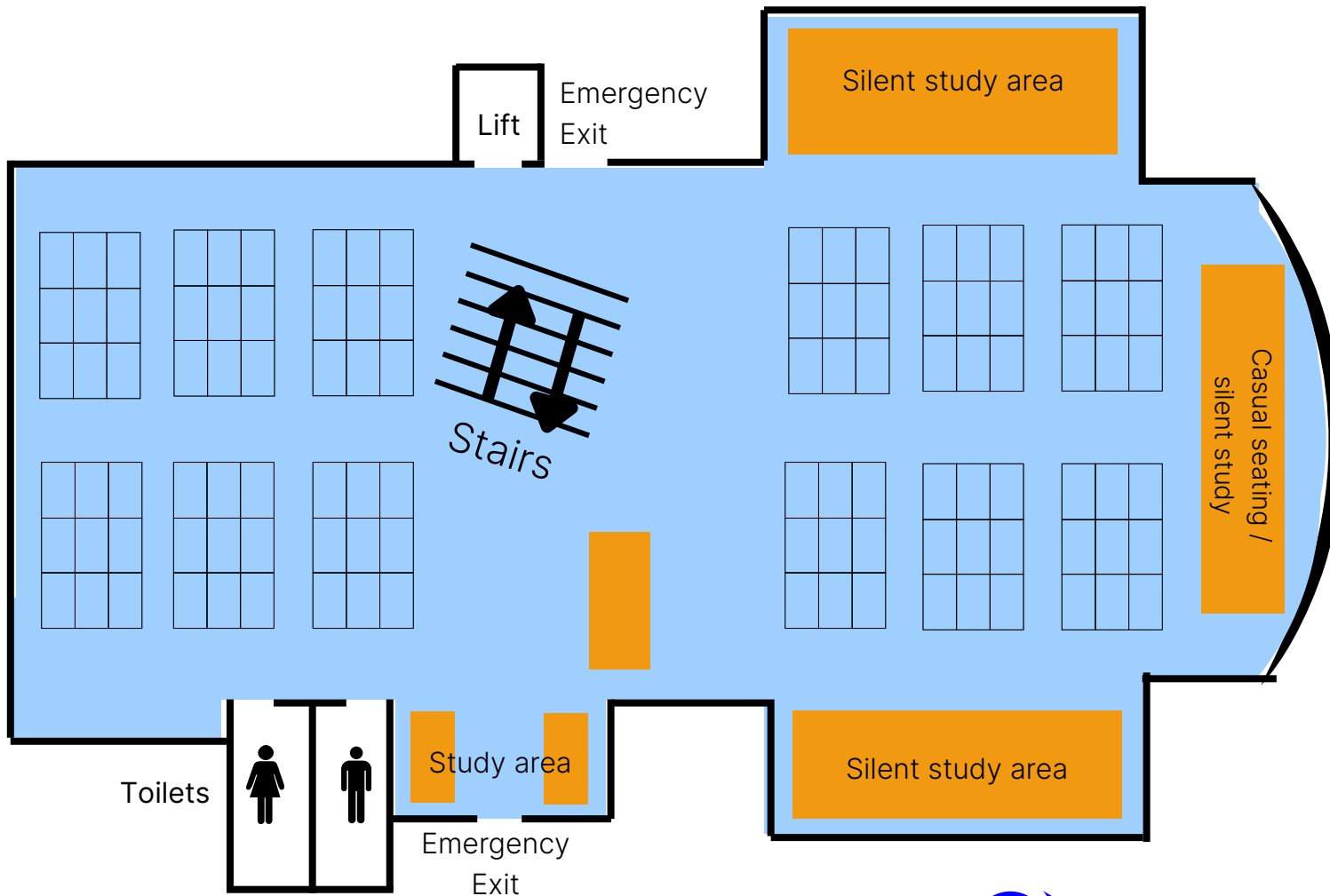



The library's atmosphere varies depending on the day and time. It can be either quiet or busy with activity.

While Federation Library does not have designated sensory spaces, some spots tend to be quieter than others, as shown on the map.

If you need assistance, please ask a library staff member.

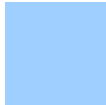
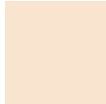
For a dedicated sensory space visit Student Connect to book room 3N-112 on the Gippsland campus

-  **Lower sensory spaces**
Quieter areas with fewer people
-  **Higher sensory spaces**
Louder areas with visual and other stimuli
-  **Seating areas**





Gippsland Library Sensory Map

Group Study Space (Level 2)

The library's atmosphere varies depending on the day and time. It can be either quiet or busy with activity.

While Federation Library does not have designated sensory spaces, some spots tend to be quieter than others, as shown on the map.

If you need assistance, please ask a library staff member.

For a dedicated sensory space visit Student Connect to book room 3N-112 on the Gippsland campus

After Hours
Entry / Exit

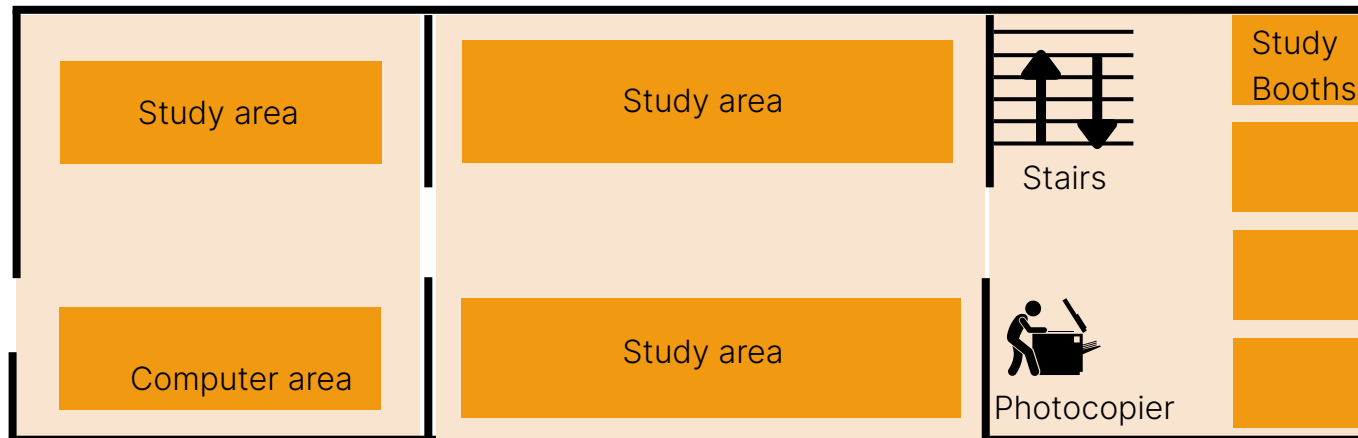

Lower sensory spaces
Quieter areas with fewer people

Higher sensory spaces
Louder areas with visual and other stimuli

Seating areas